

GEYER TOMORROW TODAY

Design development

Display suites, L3, 267 SGT

Revision [03] 09 November 2023

GEYER

Geyer is a strategic design consultancy.

With tomorrow in mind, we believe in making a difference. Through understanding people and thinking differently we use strategy-led design to create intelligent places that help our clients and their communities succeed.

Design development

Design narrative - revisited

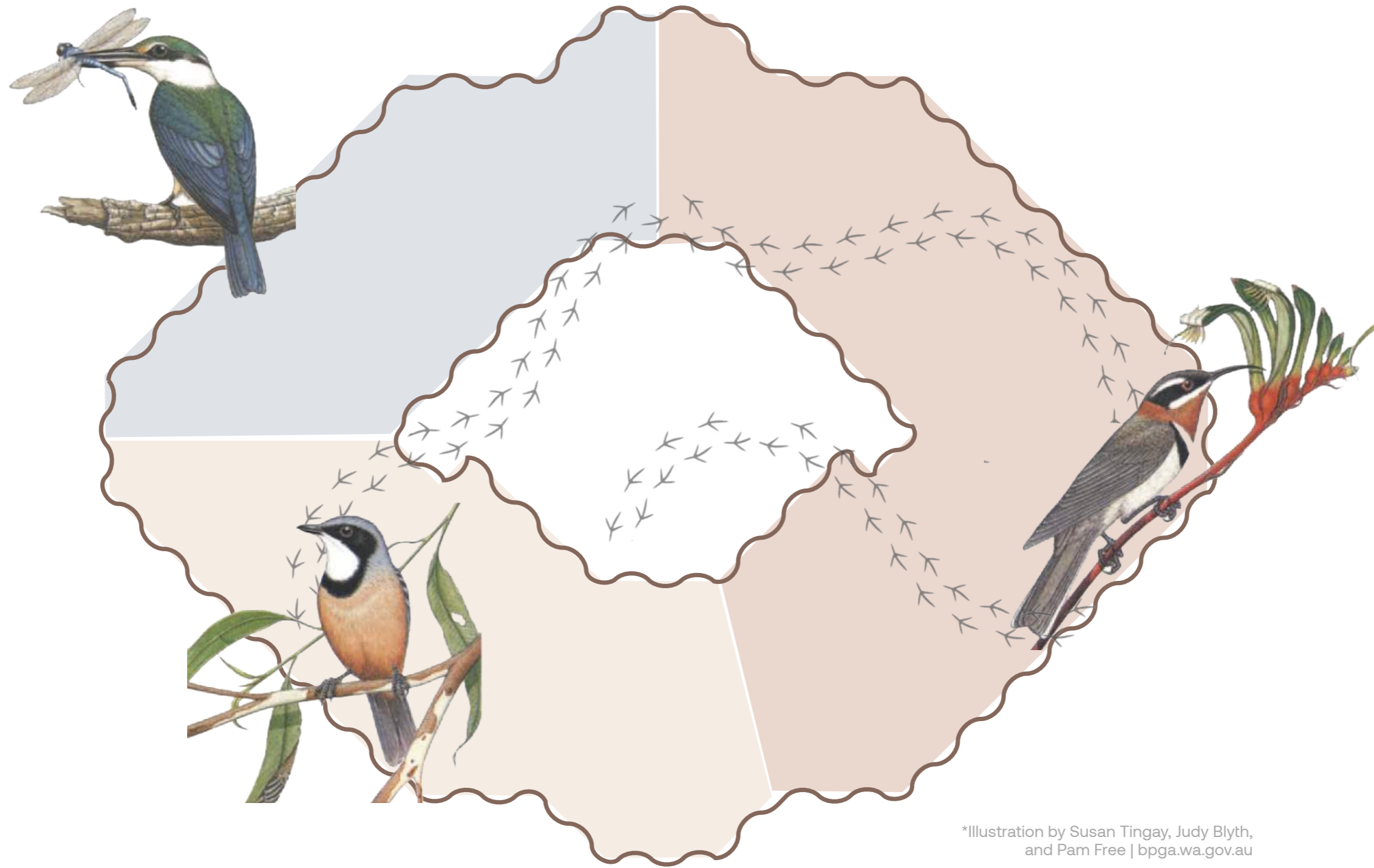

*Illustration by Susan Tingay, Judy Blyth, and Pam Free | bpga.wa.gov.au

Inspired by the colourful resident birds of Kings Park Botanical Gardens in creating a calming professional space with a visual connection with nature to improve well-being, health and productivity.

Design development Suite 1 | Birds of Kings Park



Waiting



Boardroom



Open work area



Kitchen/Breakout



Sacred Kingfisher

The colour palette used is inspired the distinctive green-blue back with cool undertones of the species, usually associated with good fortune in some cultures. Sacred Kingfisher is a breeding visitor from September to March, usually found in the woodland area.

*Illustration by Susan Tingay, Judy Blyth, and Pam Free | bpga.wa.gov.au

Design development

Suite 1 | General arrangement plan



Key areas

1. Waiting area
2. 8P boardroom
3. 5P meeting rooms
4. Open work area
5. Collaboration space
6. Breakout
7. Kitchen
8. Utilities
9. Common lobby

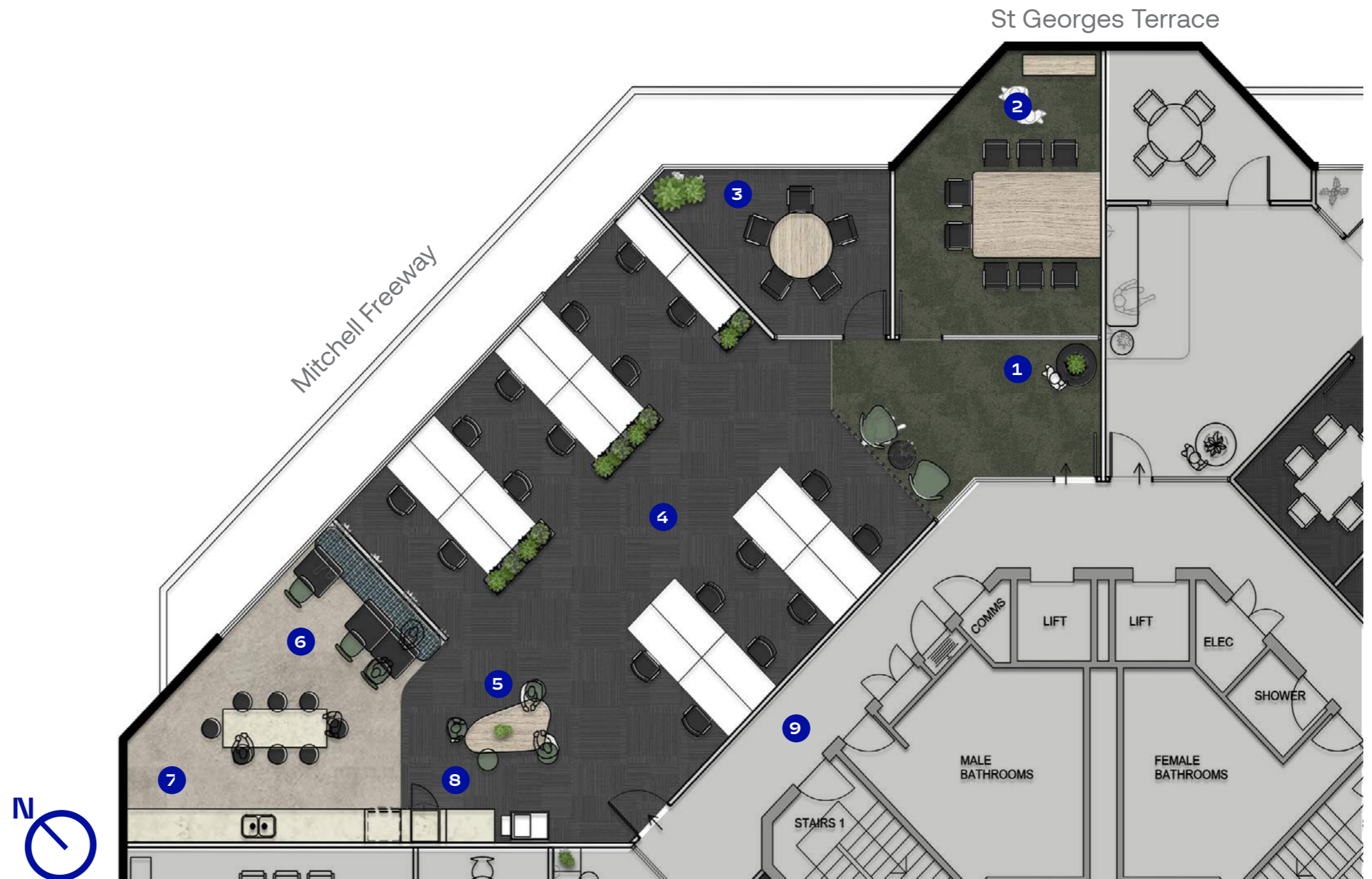

*Illustration by Susan Tingay, Judy Blyth, and Pam Free | bpga.wa.gov.au

Design development

Suite 1 | Proposed finishes palette



Key elements

1. Feature carpet - Interface composure II eucalypt
2. Concrete-look feature paint - Dulux pale elements
3. Door paint - Dulux reckless grey
4. Feature paint - Dulux backyard
5. Black powdercoat to FFE items and partition frames
6. Green powdercoat to furniture item - Dulux pale eucalypt
7. Gunmetal finish to kitchen fixtures
8. Furniture timber-look laminate - Laminex seasoned oak
9. Joinery laminate - Polytec ligurian oak
10. Kitchen benchtop laminate - Laminex pearl concrete
11. Joinery blue laminate - Laminex french navy
12. Kitchen splashback tile - Academy tiles 15553
13. Concrete-look vinyl flooring - Expona commercial grey cement
14. Breakout upholstery fabric - Instyle create fusion
15. Workstation acoustic screens - Woven image 349 vineyard
16. Curtain fabric - Zepel motion dune

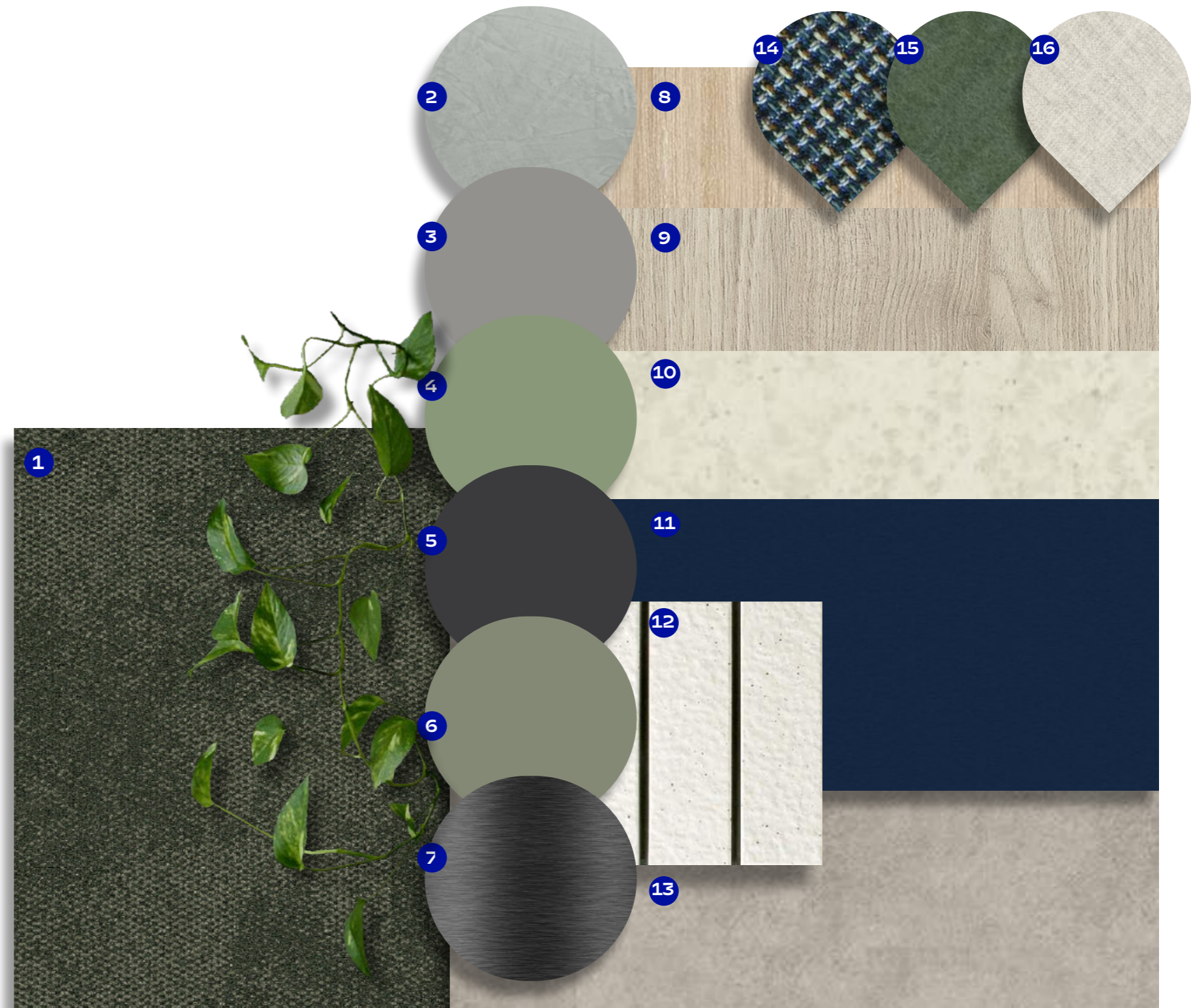

*Illustration by Susan Tingay, Judy Blyth, and Pam Free | bpga.wa.gov.au

Design development

Suite 1 | Proposed FOH FF&E items



Arm chair - 2x
Name: Arlo chair
Finish: Green fabric in black base



Side table - 1x
Name: Edge side table
Finish: Black stain

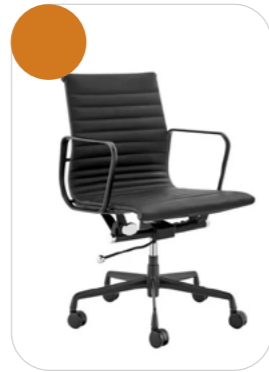

Meeting chair - 8x
Name: Eames replica
Finish: Black



8p Meeting table - 1x
Name: Co-op table
Finish: Laminex seasoned oak with matching abs edging and black frame



Credenza - 1x
Name: Humla low shelf
Finish: Black veneer + black metal legs



Key plan



Concierge table - 1x
Name: Co-op table
Finish: Black top and base

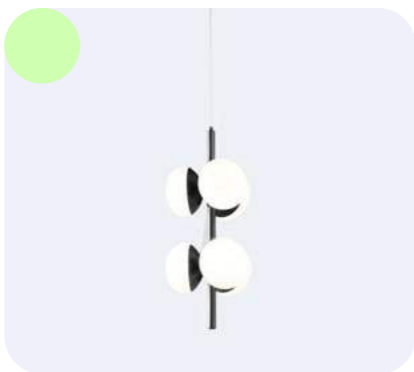

Feature pendant light - 1x
Name: Tres double
Finish: Black and opal



Meeting chair - 5x
Name: Layla chair
Finish: Green fabric in black base



5p Meeting table - 1x
Name: Custom round gen-x table
Finish: Laminex seasoned oak with matching abs edging and black frame



Feature pendant light - 1x
Name: LED ring 900mm
Finish: Black housing



Feature pendant light - 1x
Name: 2YBY5 1800mm
Finish: Black japan



Feature carpet - Interface composure eucalypt



Feature screen - metal tubes in black powdercoat

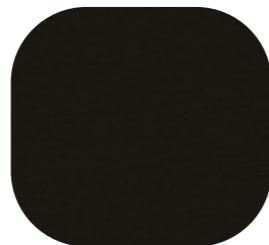

Glazing partition - Black powdercoat



Glazing film - Dusted crystal



Existing base carpet



Feature paint - Dulux backyard

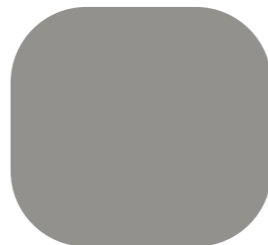

Door paint - Dulux reckless grey

Design development

Suite 1 | Proposed workarea + breakout FF&E items

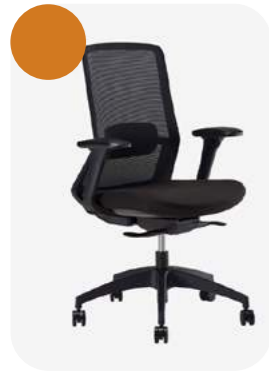

Task chair - 18x
Name: Mona chair
Finish: Black

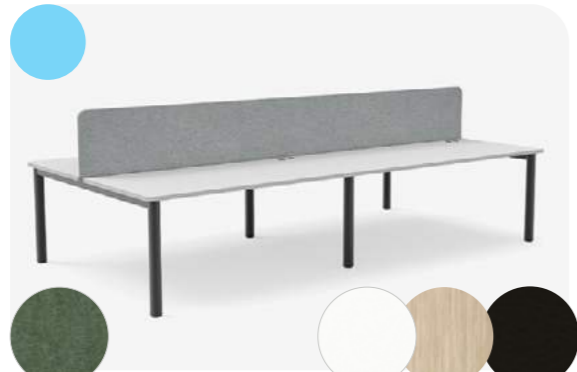

Workstations - 18x
Name: Avanti workstation
Finish: Laminex white top with timber abs edging and black frame + woven image vineyard acoustic screen

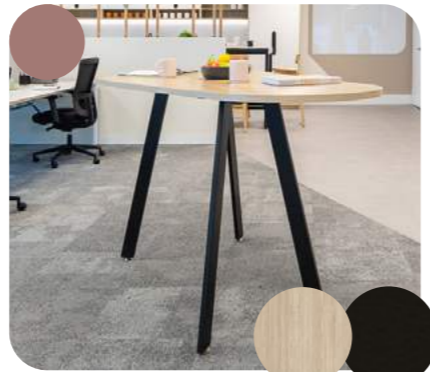

Collab table - 1x
Name: Custom organic table
Finish: Laminex seasoned oak w/ matching abs edging and black frame

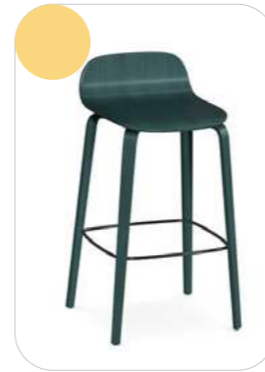

Collab chairs - 4x
Name: Indi chair
Finish: Green stain



Key plan

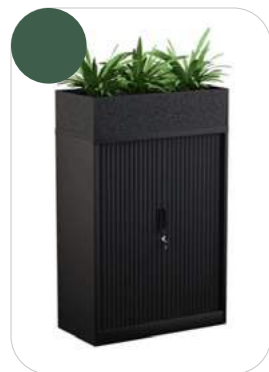

Storage - 5x
Name: Tambours with planters
Finish: Black powdercoat

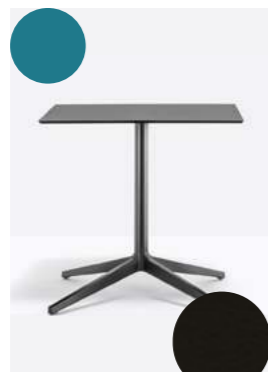

Breakout table - 3x
Name: Ypsilon table
Finish: Black top and base

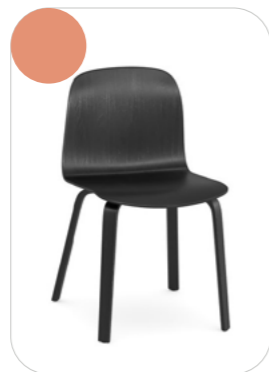

Breakout chair - 3x
Name: Indi chair
Finish: Black stain



Ottoman - 2x
Name: Custom ottoman
Finish: Instyle create fusion upholstery fabric in black base



Breakout high table - 1x
Name: H-frame high table
Finish: Polytec pearl concrete top w/ matching abs edge + black base



Breakout high chair - 6x
Name: Pendant stool
Finish: Black



Existing base carpet



Feature screen - metal tubes in black powdercoat

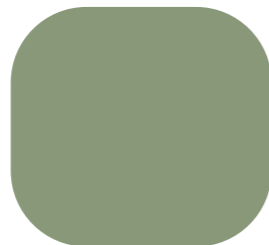

Feature paint - Dulux backyard



Feature paint - Dulux pale elements

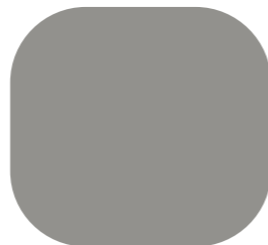

Door paint - Dulux reckless grey



Feature carpet - Expona commercial grey cement



Joinery laminate - Polytec ligurian oak



Benchttop laminate - Laminex pearl concrete



Joinery laminate - Laminex french navy

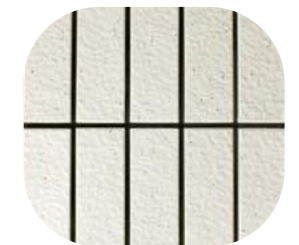

Kitchen splashback - Academy tiles 15553

Design development

Suite 1 | Elevation - kitchen



black appliances

concrete-look feature paint

splashback tiles



Mixer - 1x
Name: Elyssian kitchen mixer
Finish: Black



Sink - 1x
Name: Vera double sink
Finish: Black



Fridge - 1x
Name: LG Fridge GB455-BTL
Finish: Black



Microwave - 1x
Name: Freestanding microwave
Finish: Black



Dishwasher - 1x
Name: Freestanding dishwasher
Finish: Black

Design development Suite 2 | Birds of Kings Park



Waiting

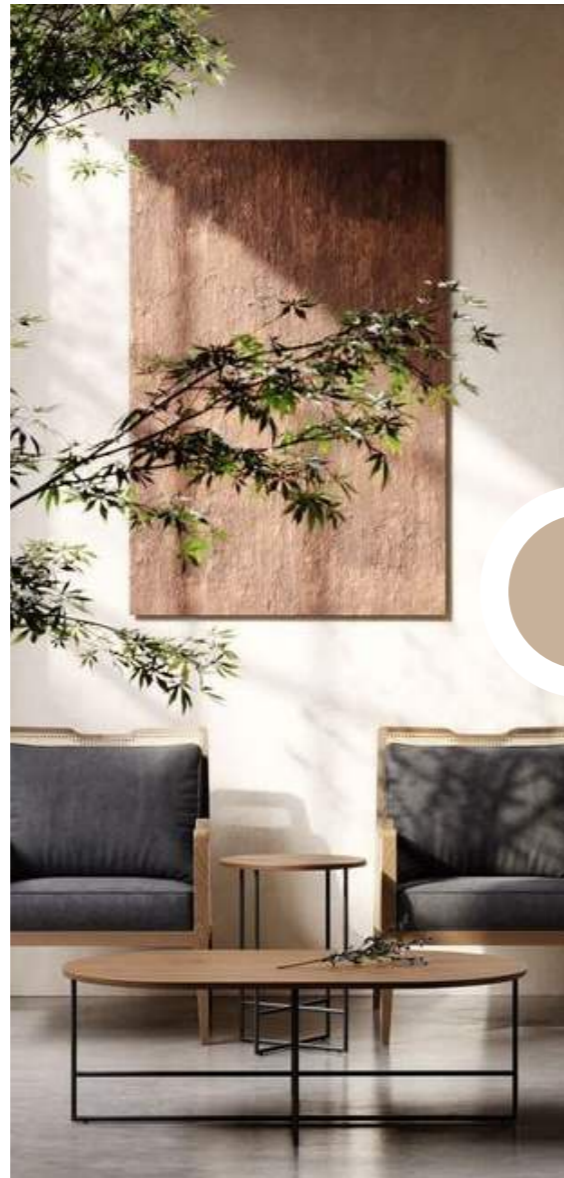

Boardroom



Open work area

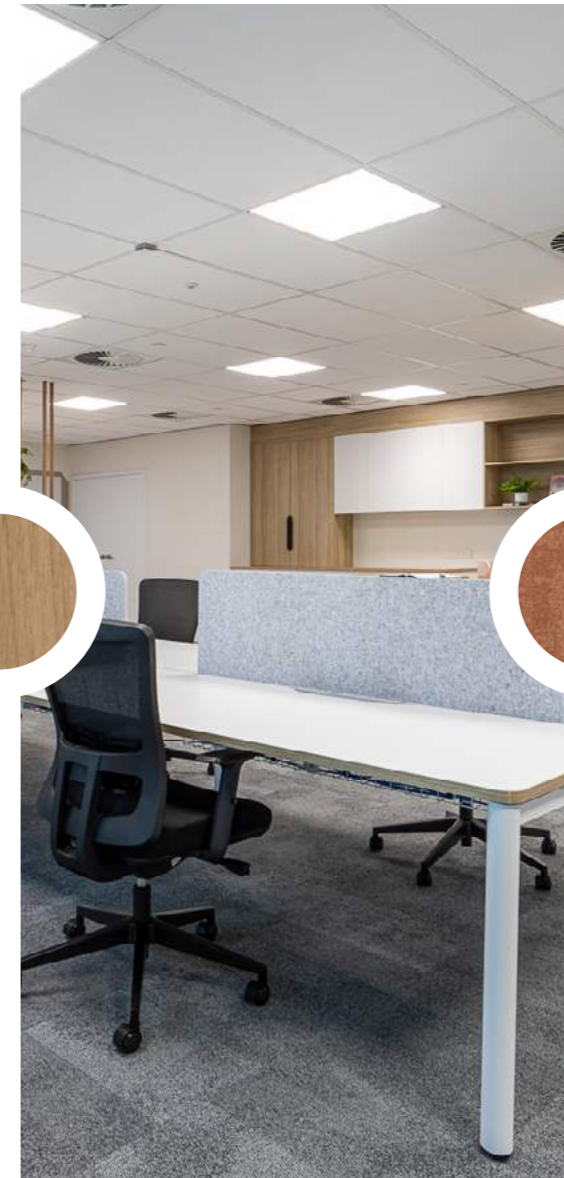

Kitchen/Breakout



Western Spinebill

Western Spinebill is a small honeyeater with fine, black curved beak mostly found in the gardens of Southwest WA. The colour palette used is derived from the profile of the Western Spinebill which is tints and shades of orange/tan.

*Illustration by Susan Tingay, Judy Blyth, and Pam Free | bpga.wa.gov.au

Design development

Suite 2 | General arrangement plan

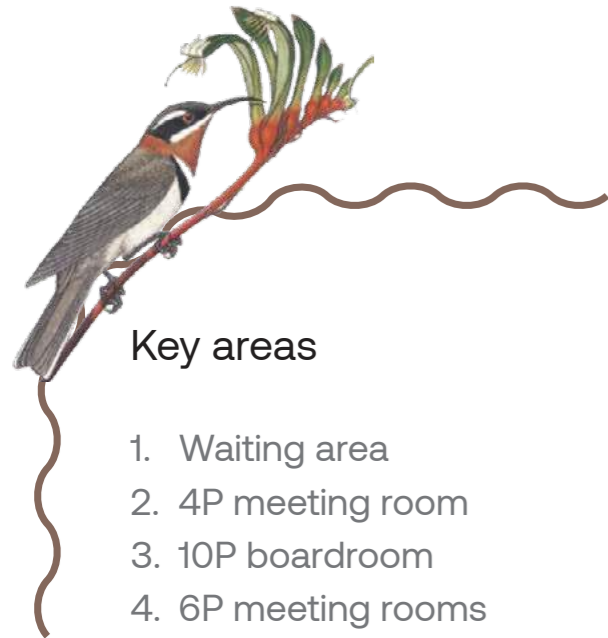

Key areas

1. Waiting area
2. 4P meeting room
3. 10P boardroom
4. 6P meeting rooms
5. Utilities
6. Open work area
7. Collaboration space
8. Kitchen + breakout zone
9. Offices
10. Informal meet
11. Common lobby



*Illustration by Susan Tingay, Judy Blyth, and Pam Free | bpga.wa.gov.au

Design development

Suite 2 | Proposed finishes palette

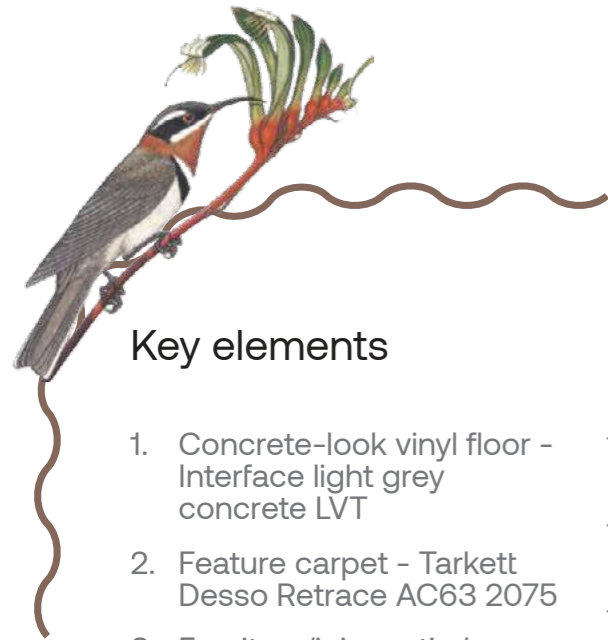

Key elements

1. Concrete-look vinyl floor - Interface light grey concrete LVT
2. Feature carpet - Tarkett Desso Retrace AC63 2075
3. Furniture/joinery timber laminate - Laminex planked urban oak
4. Joinery laminate - Polytec prime oak matt
5. Kitchen benchtop laminate - Polytec grey cement matra
6. Joinery laminate - Polytec antique matt
7. Furniture laminate - Laminex french cream
8. Curtain fabric - Zepel motion dune
9. Upholstery fabric - Instyle chunky profile
10. Workstation acoustic screen - Woven image echopanel 454
11. Kitchen splashback tile - Academy tiles 15557
12. Feature paint - Dulux stetson
13. Door paint - Dulux harvest town
14. Concrete-look feature paint - Dulux pale elements
15. Black powdercoat to FFE items and partition frame
16. Base powdercoat to joinery items - Duralloy terrain
17. Brushed copper to kitchen fixtures

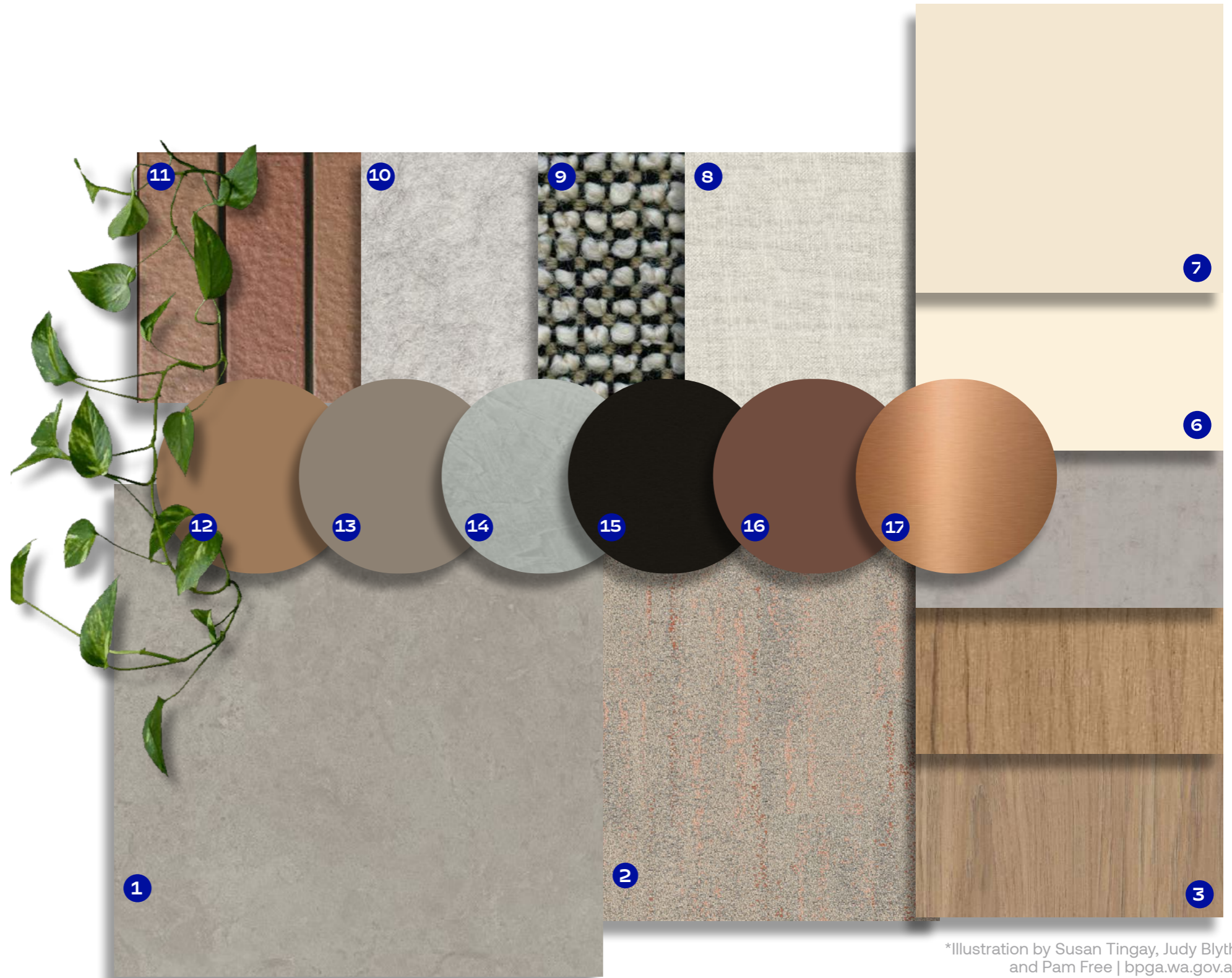

*Illustration by Susan Tingay, Judy Blyth, and Pam Free | bpga.wa.gov.au

Design development

Suite 2 | Proposed FOH FF&E items



Concierge table - 1x
 Name: Co-op table
 Finish: Laminex black w/ brushed copper abs edge + black base



Side table - 1x
 Name: Captivate side table
 Finish: Oak clear stain



Ottoman - 1x
 Name: Custom lounge ottoman
 Finish: Maharam merit macaron fabric in black base



4P Meeting table - 1x
 Name: Custom round gen-x
 Finish: Laminex planked urban oak top with matching abs edge + black base



Meeting chair - 4x
 Name: Fortona light
 Finish: Taupe house fabric



Key plan



6P Meeting table - 1x
 Name: Gen-x table
 Finish: Laminex planked urban oak top w/ matching abs edge + black base



Meeting chair - 6x
 Name: Fortona light
 Finish: Taupe house fabric



10p Meeting table - 1x
 Name: Gen-x table
 Finish: Laminex planked urban oak top with matching abs edge + black base

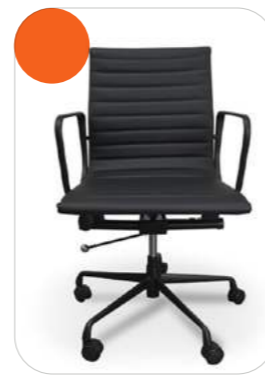

Meeting chair - 10x
 Name: Eames replica
 Finish: Matte black

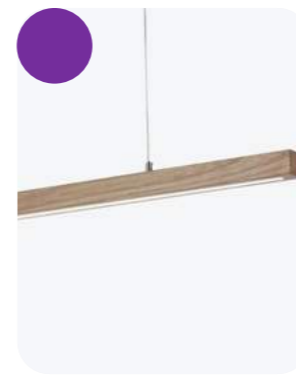

Linear pendant light - 1x
 Name: 2BY5 2000mm
 Finish: Natural



Wall light - 2x
 Name: Florence travertine wall light
 Finish: white/brass

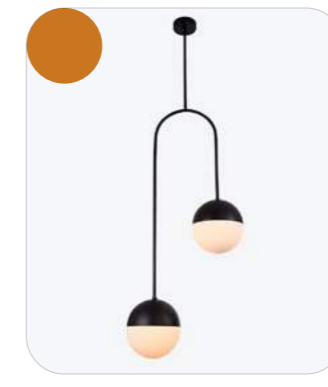

Pendant light - 1x
 Name: Amendo 2
 Finish: Black housing

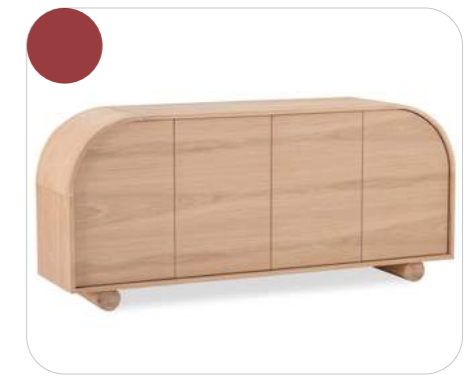

Loose Credenza - 1x
 Name: Muse
 Finish: Oak



Feature carpet - Interface shallows dessert



Vinyl flooring - Interface light grey concrete LVT



Existing base carpet

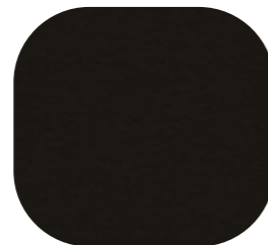

Glazing partition - Black powdercoat



Glazing film - Dusted crystal

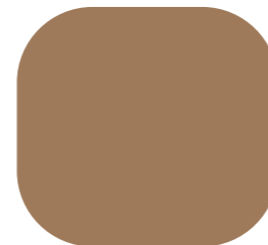

Feature paint - Dulux stetson

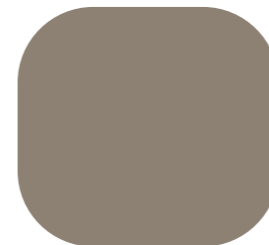

Door paint - Dulux harvest town

Design development

Suite 2 | Proposed workarea FF&E items



Workstations - 34x
 Name: Avanti workstation
 Finish: Laminex white table top
 w/ timber abs edge + black base
 and woven image 454 acoustic screen

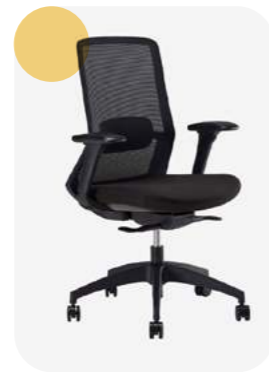

Task chairs - 34x
 Name: Mona task chair
 Finish: Black



Storage - 10x
 Name: Tambours with planters
 Finish: Black PC



Collab table - 1x
 Name: Co-op table
 Finish: Laminex morrocan clay
 matching abs edge and
 black base



Collab chair - 4x
 Name: Dash stool
 Finish: Black

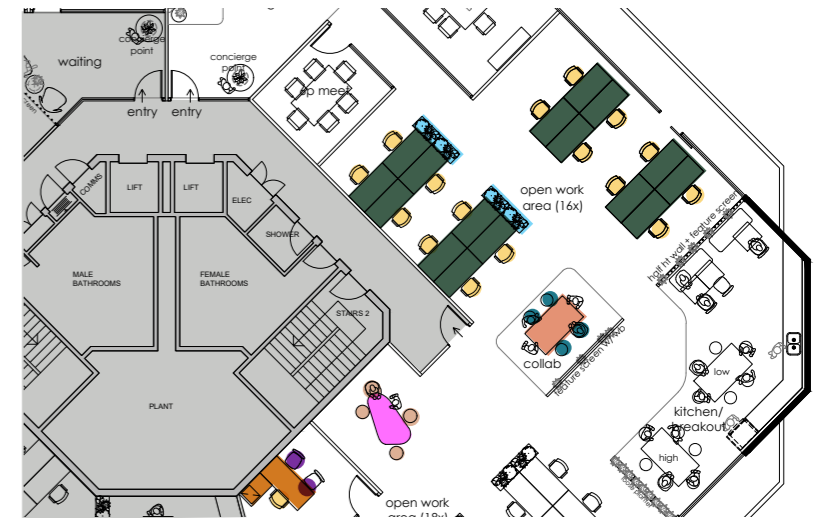

Key plan



Office desk - 1x
 Name: L-shaped avanti desk
 Finish: white top with timber
 abs edge + black base

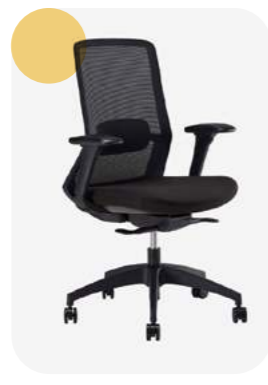

Task chairs - 1x
 Name: Mona task chair
 Finish: Black



Visitor chairs - 2x
 Name: Fortona light sled chair
 Finish: Musk fabric and black base



Collab table - 1x
 Name: Custom organic table
 Finish: Laminex planked urban oak
 with matching abs edge
 and black base



Collab chairs - 3x
 Name: Pendant stool
 Finish: Black

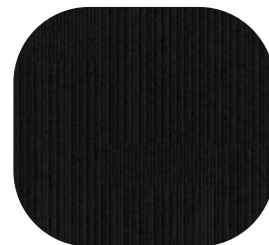

Existing base carpet

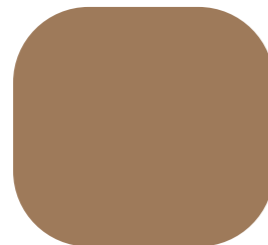

Feature paint -
 Dulux stetson

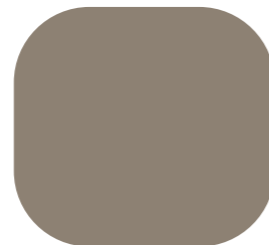

Door paint -
 Dulux harvest town



Joinery laminate -
 Polytec prime oak
 woodmatt



Feature carpet -
 Interface shallows
 dessert

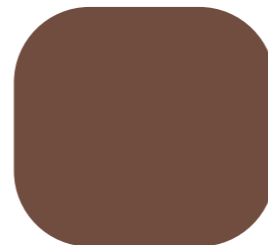

Feature screen
 powdercoat -
 Duralloy terrain



Feature screen -
 Porta timber dowel in
 tasmanian oak

Design development

Suite 2 | Proposed workarea FF&E items



Workstations - 34x
Name: Avanti workstation
Finish: Laminex white table top w/ timber abs edge + black base and woven image 454 acoustic screen

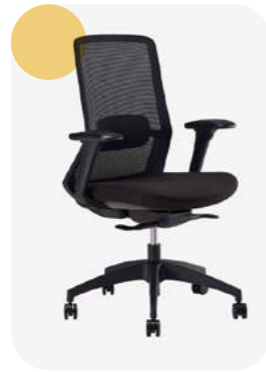

Task chairs - 34x
Name: Mona task chair
Finish: Black



Storage - 10x
Name: Tambours with planters
Finish: Black PC

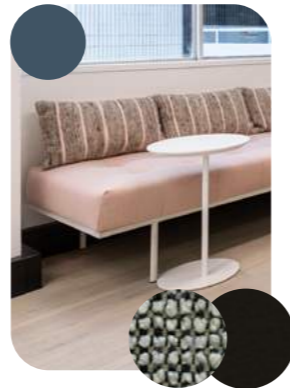

Loose ottoman - 2x
Name: Custom lounge ottoman
Finish: Instyle chunky profile fabric and black

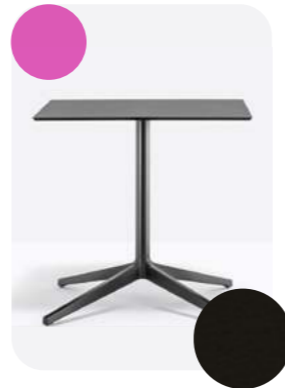

Dining table - 3x
Name: Ypsilon table
Finish: Black top + base



Dining chairs - 3x
Name: Indi chair
Finish: Black

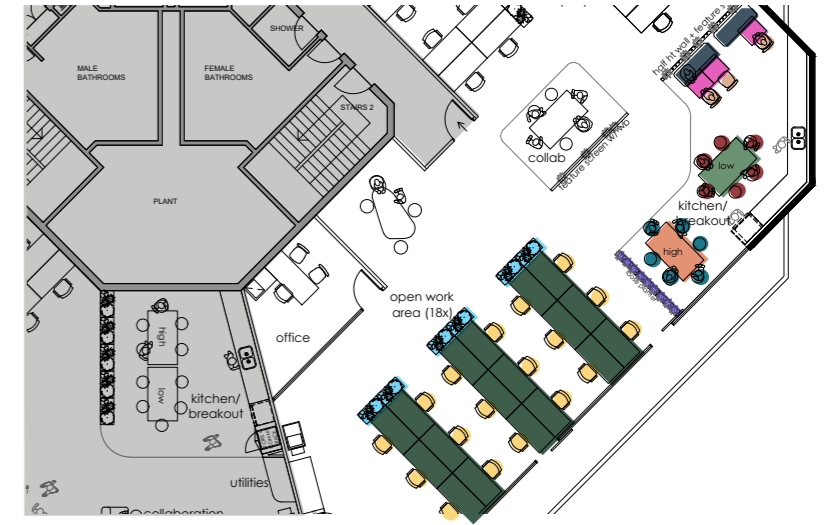

Key plan



Breakout high table - 1x
Name: Co-op table
Finish: Laminex french cream w/ brushed copper abs edging + terrain powdercoated base



High stools - 6x
Name: Max II high stool
Finish: Duralloy stone beige powdercoat



Breakout low table - 1x
Name: Co-op table
Finish: Laminex french cream w/ brushed copper abs edging + terrain powdercoated base



Low stools - 6x
Name: Max II low stool
Finish: Duralloy stone beige powdercoat



Planter screens - 3x
Name: O.C Vertical planter
Finish: Black powdercoat



Pendant light - 2x
Name: Lova 1500mm
Finish: Coffee housing

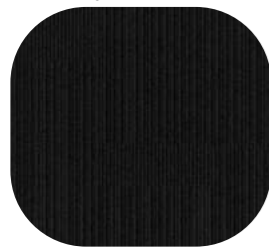

Existing base carpet

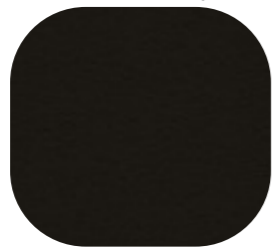

Glazing partition - Black powdercoat



Glazing film - Dusted crystal



Vinyl flooring - Interface light grey concrete LVT



Overhead laminate - Laminex french cream



Base laminate - Polytec prime oak matt



Benchtop laminate - Polytec grey cement

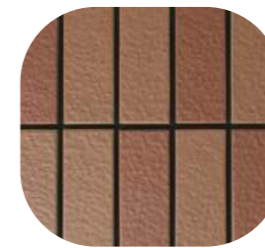

Kitchen splashback tiles - Academy tiles 15557

Design development

Suite 2 | Elevation - waiting

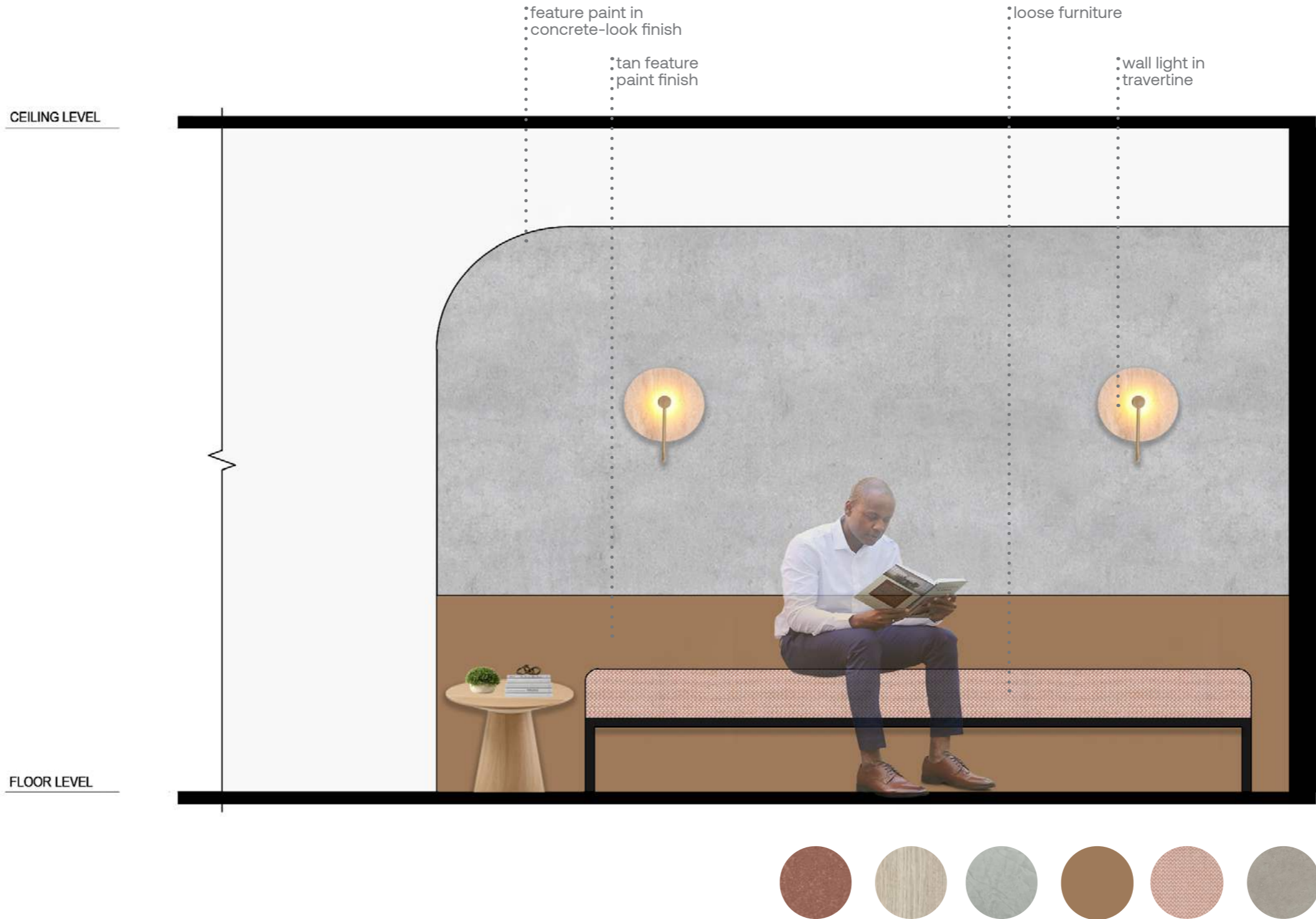

Design development

Suite 2 | Elevation - kitchen

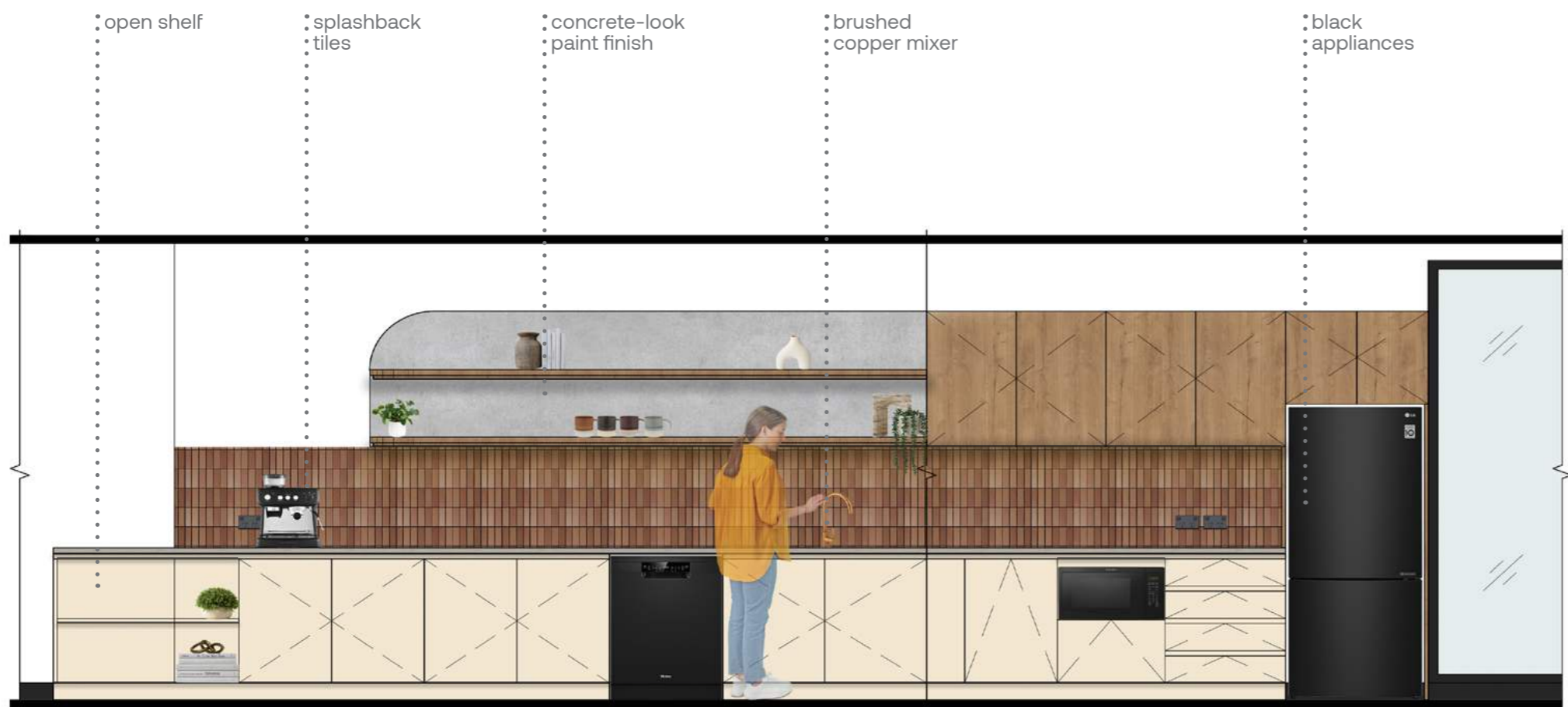

open shelf

splashback tiles

concrete-look paint finish

brushed copper mixer

black appliances



Mixer - 1x
Name: Elyssian kitchen mixer
Finish: Brushed copper



Sink - 1x
Name: Vita kitchen sink
Finish: Brushed copper



Fridge - 1x
Name: LG Fridge GB455-BTL
Finish: Black



Microwave - 1x
Name: Freestanding microwave
Finish: Black



Dishwasher - 1x
Name: Freestanding dishwasher
Finish: Black



Design development Suite 3 | Birds of Kings Park



Waiting



Boardroom

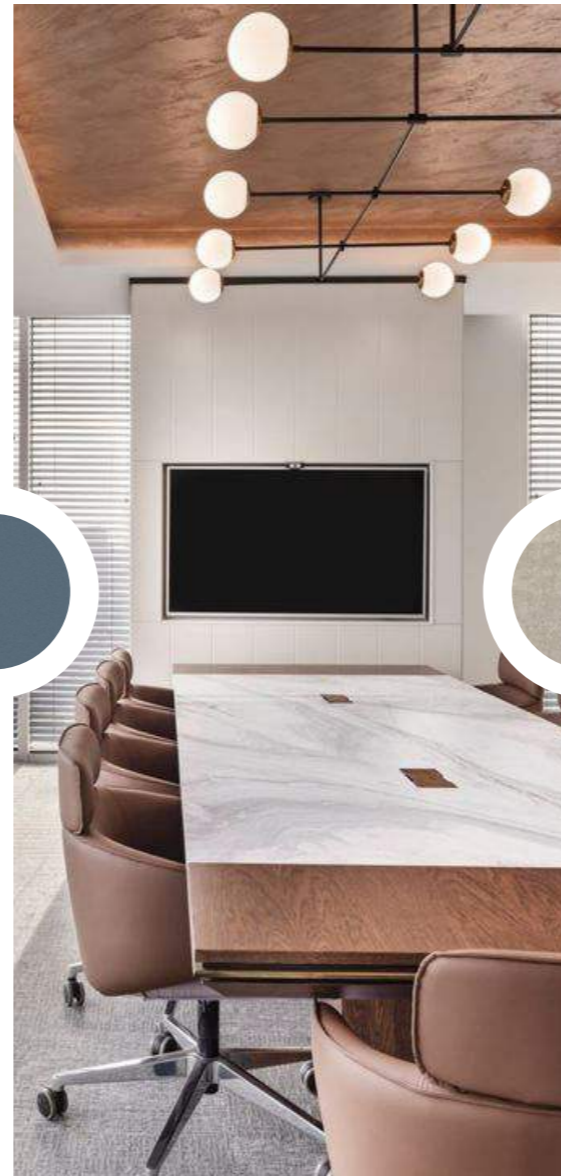

Collaboration



Kitchen/Breakout



Rufous Whistler

Usually found in Jarrah woodland often heard by its musical calls. The colour palette used is based on its muted bluish-grey body with streaks of reddish brown underparts.

*Illustration by Susan Tingay, Judy Blyth, and Pam Free | bpga.wa.gov.au

Design development

Suite 3 | General arrangement plan



Key areas

1. Waiting area
2. 4P meeting rooms
3. 10P boardroom
4. Open work area
5. Collaboration space
6. Breakout
7. Kitchen
8. Utilities

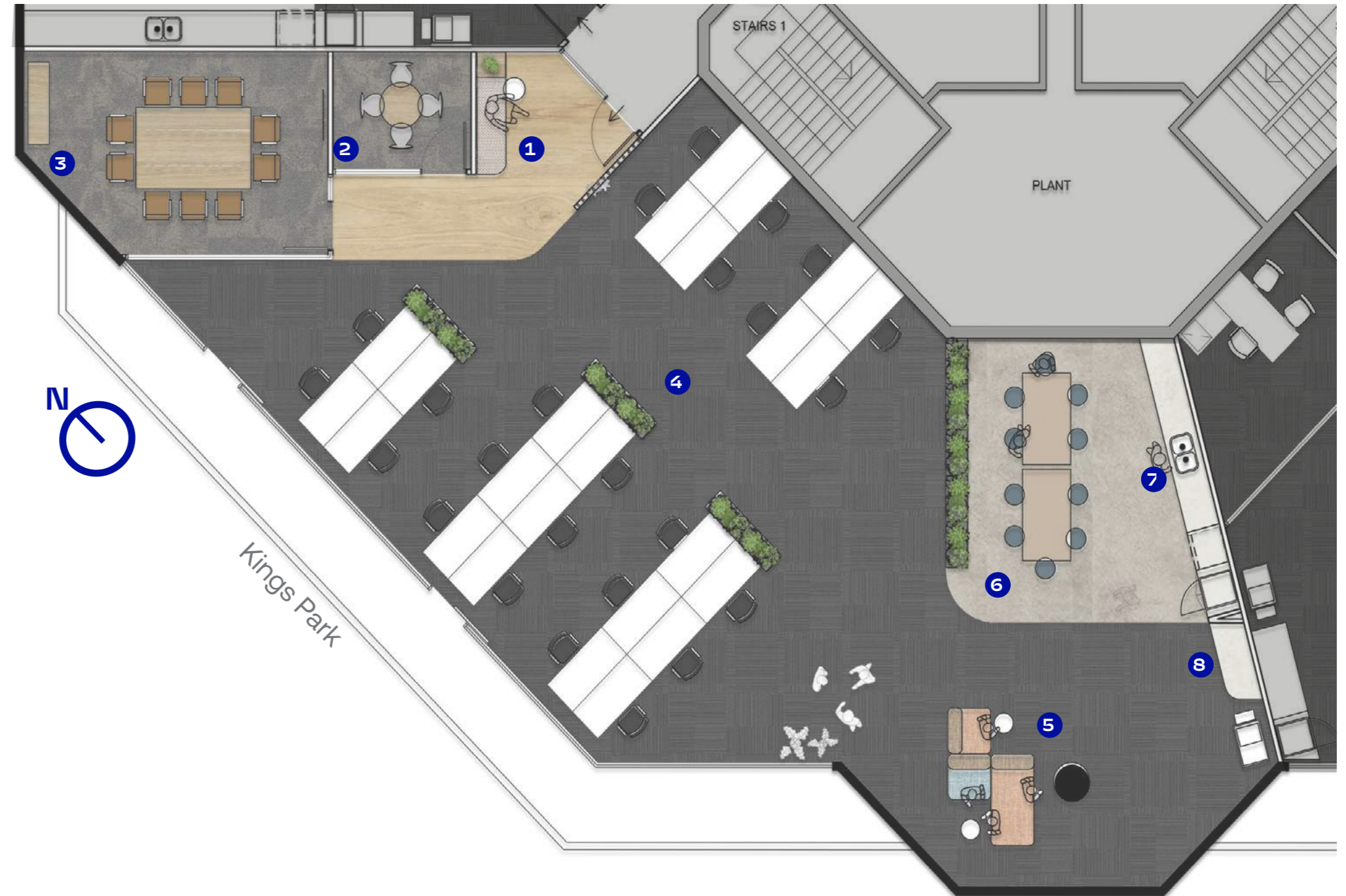

Design development

Suite 3 | Proposed finishes palette

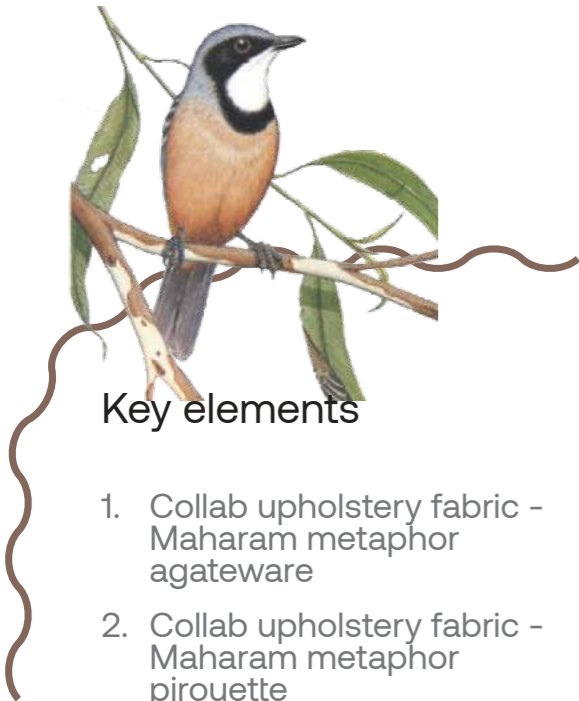

Key elements

1. Collab upholstery fabric - Maharam metaphor agateware
2. Collab upholstery fabric - Maharam metaphor pirouette
3. Collab upholstery fabric - Maharam metaphor gazebo
4. Waiting upholstery fabric - Maharam merit farro
5. Kitchen splashback tile - Academy tiles intariyo border 14955
6. Kitchen benchtop laminate - Polytec white cement venette
7. Joinery/furniture laminate - Polytec habitat matera
8. Furniture laminate - Laminex classic oak
9. Joinery laminate - Polytec natural oak
10. Joinery base cupboard laminate - Laminex peruvian clay
11. Feature carpet - Interface composure deliberate
12. Door paint - Dulux wistow
13. Feature paint - Dulux love day
14. Concrete-look feature paint - Dulux pale elements
15. Furniture base powdercoat - Duralloy blue ridge satin
16. Furniture base powdercoat - Duralloy jasper
17. Furniture base powdercoat - Duralloy stone beige
18. Kitchen flooring - Expona commercial light grey concrete 5167
19. Curtain fabric - Zepel motion dune
20. Kitchen vinyl flooring - GH Commercial river oak



*Illustration by Susan Tingay, Judy Blyth, and Pam Free | bpga.wa.gov.au

Design development

Suite 3 | Proposed FOH FF&E items



Loose ottoman - 1x
Name: Custom ottoman
Finish: Maharam merit farro upholstery fabric and river gum beige pc



Side table - 1x
Name: My stamp side table
Finish: White/travertine

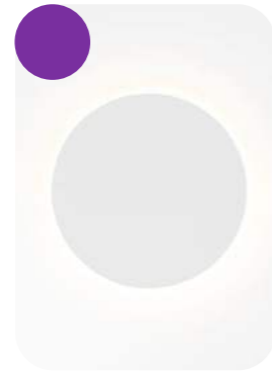

Wall lights - 4x
Name: Fade
Finish: White



4P Meeting room - 1x
Name: Custom halo table
Finish: Laminex classic oak top w/ matching abs edging + black base



Meeting chairs - 4x
Name: Layla chair
Finish: Grey fabric



Pendant light - 1x
Name: Saturn 1
Finish: Black



Key plan



10P Boardroom table - 10x
Name: Co-op table
Finish: Laminex classic oak top w/ matching abs edging + black base



Meeting chairs - 10x
Name: Eames replica
Finish: Tan/black



Credenza - 1x
Name: State 4 door sideboard
Finish: Oak



Linear pendant - 2x
Name: Vara linear 1800mm
Finish: Black



Vinyl flooring -
GHC Olympus
River oak 540

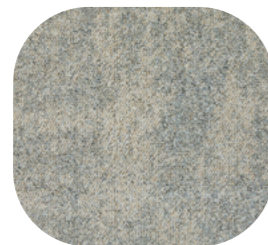

Feature carpet -
Interface CE100
survey



Feature carpet -
Interface CE200
survey/consider



Feature carpet -
Interface CE100
consider



Feature screen -
Porta timber dowel in
tasmanian oak

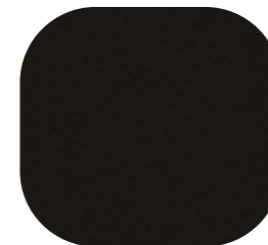

Glazing partition -
Black powdercoat



Glazing film -
Dusted crystal



Feature paint - Dulux
loveday



Door paint - Dulux
wistow

Design development

Suite 3 | Proposed workarea FF&E items



Workstations - 24x
 Name: Avanti workstations
 Finish: Laminex white top with timber abs edging and black base and instyle oxide acoustic screen

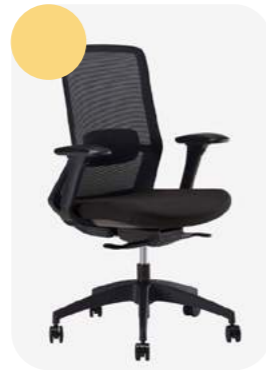

Task chairs - 24x
 Name: Mona chair
 Finish: Black



Storage - 11x
 Name: Tambours with planters
 Finish: Black powdercoat

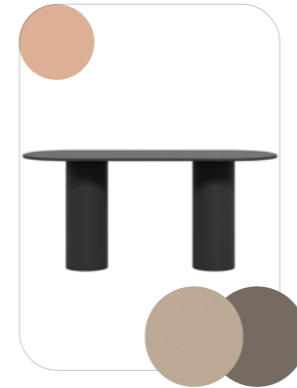

High table - 1x
 Name: Co-op table
 Finish: Laminex peruvian clay duralloy jasper base

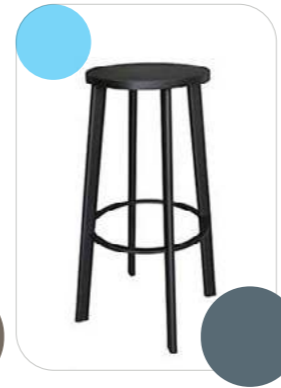

High stools - 4x
 Name: Max II bar stool
 Finish: Duralloy blue ridge satin

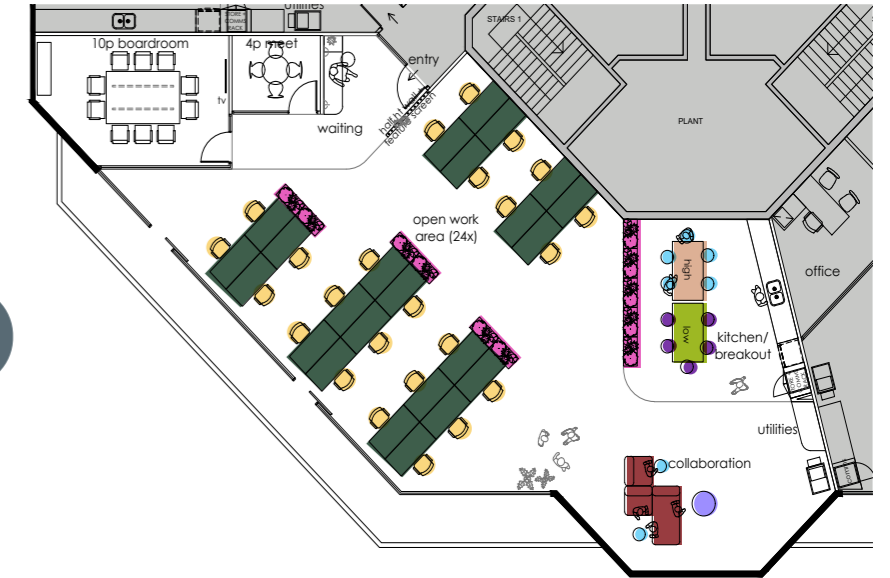

Key plan



Modular seating - 3x
 Name: Custom modular ottoman
 Finish: Maharam metaphor upholstery fabric in agataware, piroutte and gazebo

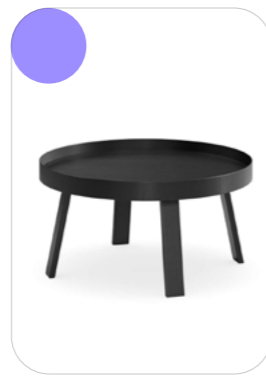

Coffee table - 1x
 Name: Nest coffee table
 Finish: Black

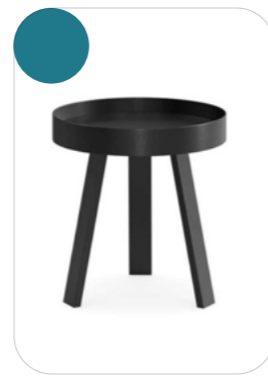

Side table - 2x
 Name: Nest side table
 Finish: Black

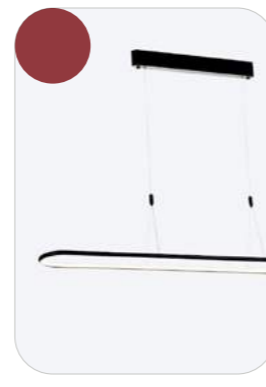

Feature light- 1x
 Name: Deen 1800mm
 Finish: Black housing

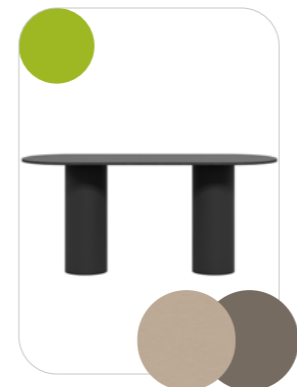

Low table - 1x
 Name: Co-op table
 Finish: Laminex peruvian clay + duralloy jasper base

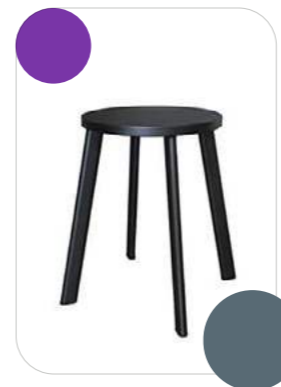

Low stools - 4x
 Name: Max II low stool
 Finish: Duralloy blue ridge satin

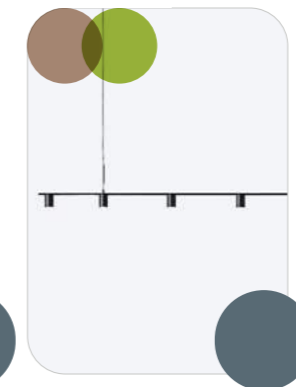

Feature light - 2x
 Name: Capri 6
 Finish: Nickel housing



Existing base carpet



Glazing partition - Black powdercoat



Glazing film - Dusted crystal

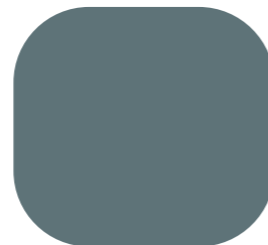

Feature paint - Dulux loveday

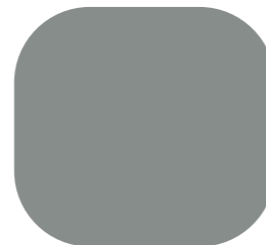

Door paint - Dulux wistow



Joinery laminate - Polytec natural oak



Joinery laminate - Polytec white cement smooth



Joinery laminate - Polytec habitat venette



Splashback tile - Academy tiles intariyo border



Feature paint - Dulux pale elements

Design development

Suite 3 | Elevation - waiting



Design development

Suite 3 | Elevation - kitchen

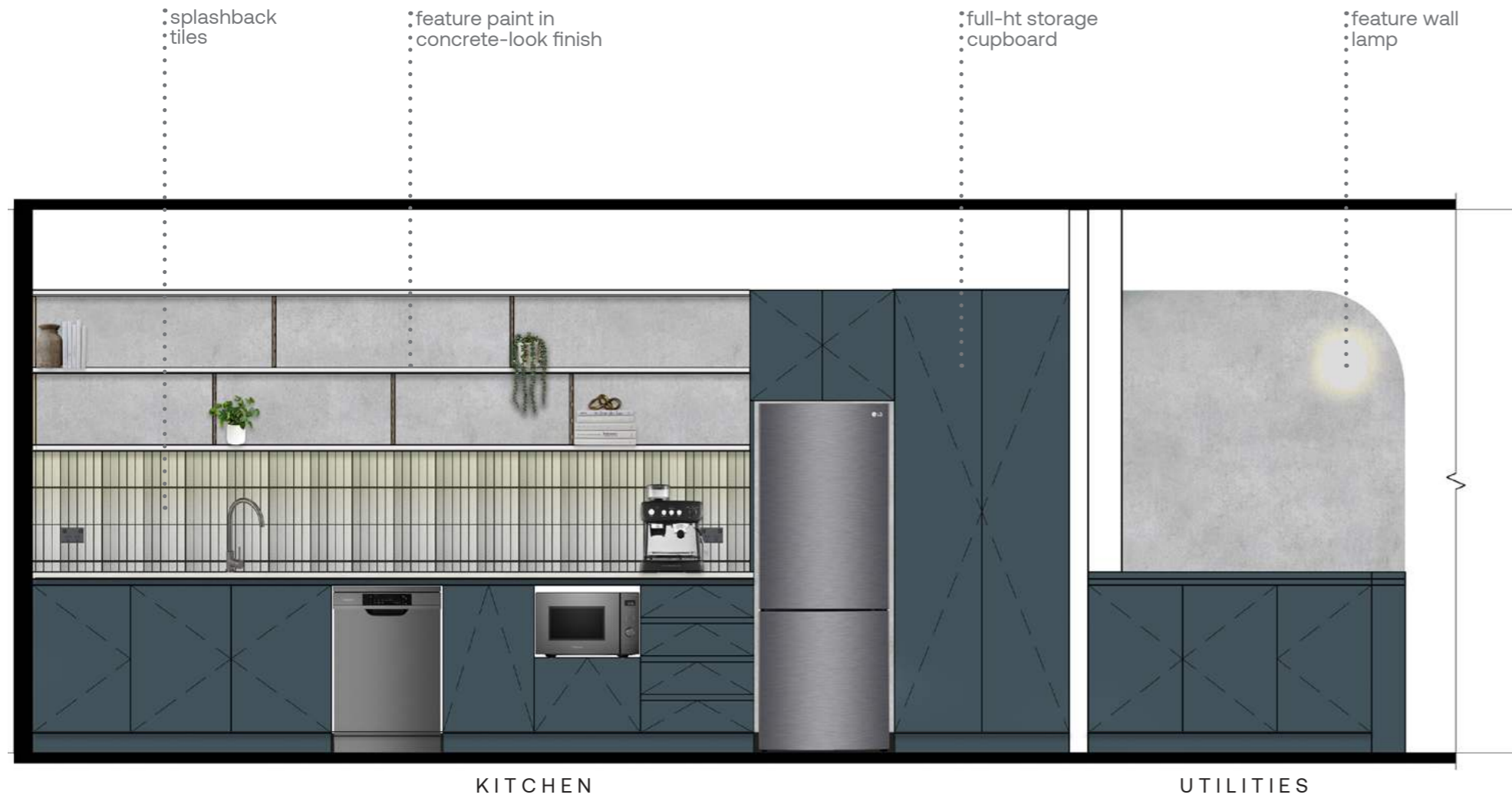

Mixer - 1x
Name: Elyssian kitchen mixer
Finish: Brushed gunmetal



Sink - 1x
Name: Zalo double sink
Finish: Brushed gunmetal



Fridge - 1x
Name: Fridge
Finish: Dark graphite



Microwave - 1x
Name: Freestanding microwave
Finish: Brushed gunmetal



Dishwasher - 1x
Name: Freestanding dishwasher
Finish: Brushed gunmetal

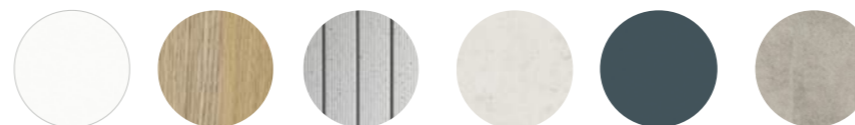

Appendices

A

Design development

Building context



Building analysis

Address: L3, 267 St Georges Terrace
Perth, W.A. 6000

Levels: 4 Levels

Amenities: EOT Facilities
Onsite parking
Bike storage

Strengths & Opportunities

- Located in west-end of CBD
- Accessible to North and South freeways
- Accessible public transport
- Efficient floor plates with access to natural lighting
- New exclusive EOT facilities including showers and bicycle facilities
- 4 Star NABERS Energy Rating

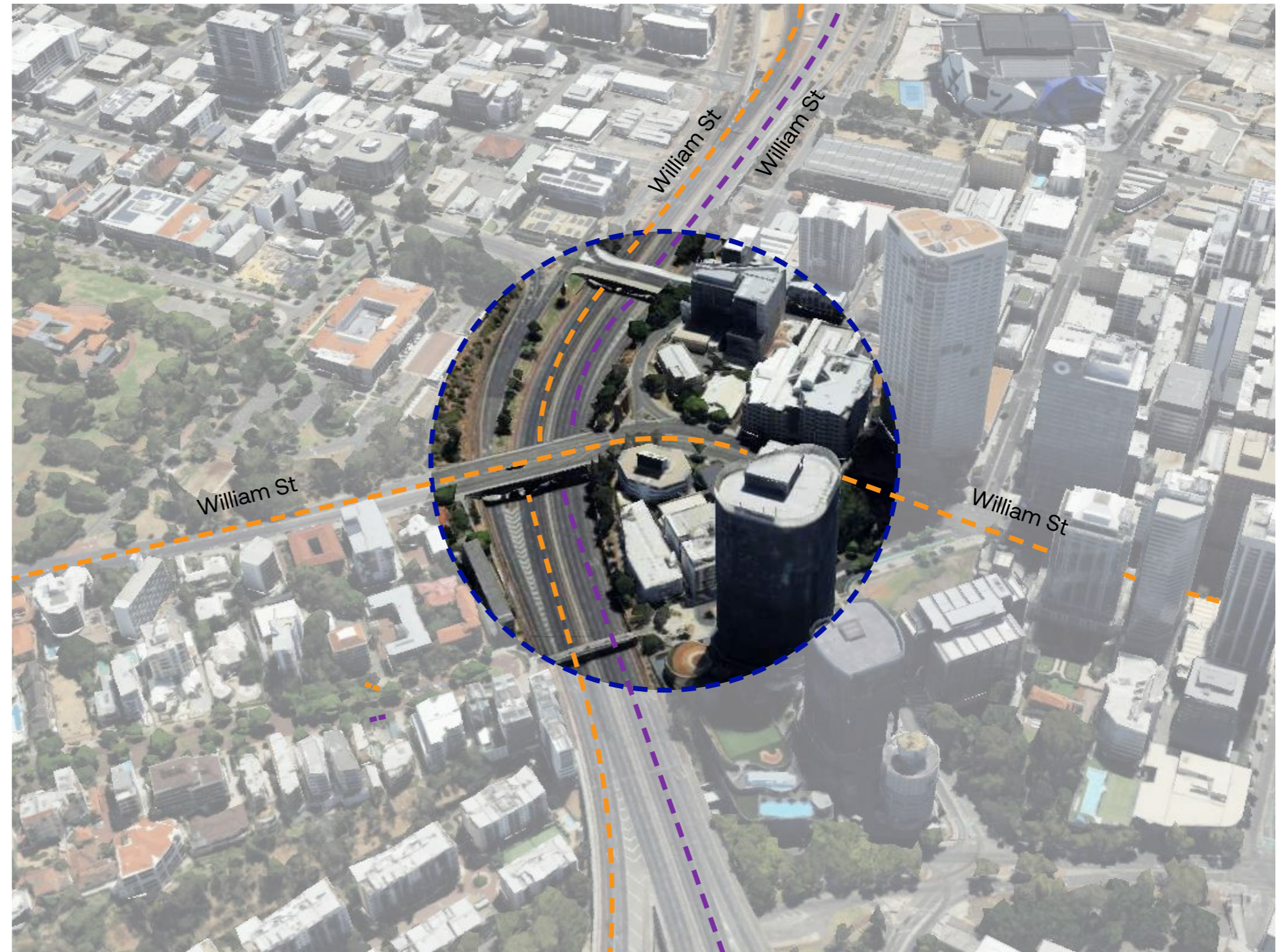

Design development

Key highlights



- 1. Parliament House
- 2. Kings Park Botanical Garden
- 3. Florence Hummerton reserve
- 4. QV building
- 5. Cloisters
- 6. Perth Convention Centre



- 7. QV1 Plaza
- 8. Mount Street Breakfast Bar
- 9. Brookefield Place
- 10. Shafto Lane



- 11. St Georges Tce Mount Street bus stop
- 12. Malcom St Harvest Tce bus stop
- 13. Perth bus station

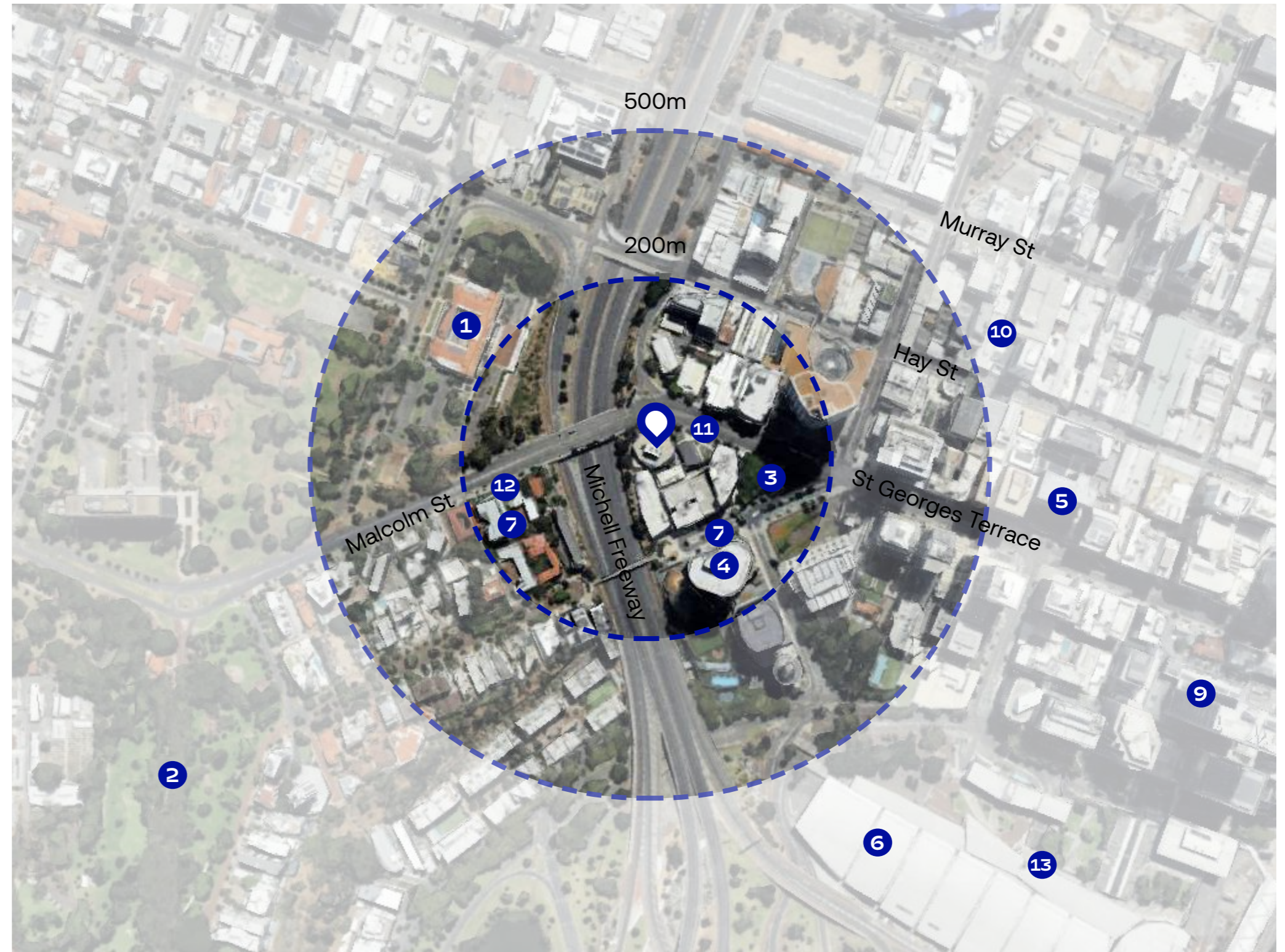

Design development

Site analysis



legend

- Entry / Exit
- Lifts
- Amenities
- Fire escape stairs
- Light penetration
- Notable views
- Sun path
- Out of Scope

Key elements

1. Waiting area
2. Boardroom and meeting rooms
3. Open work area
4. Collaboration space
5. Kitchen and breakout zone
6. Offices
7. Utilities
8. Storage
9. Common lobby

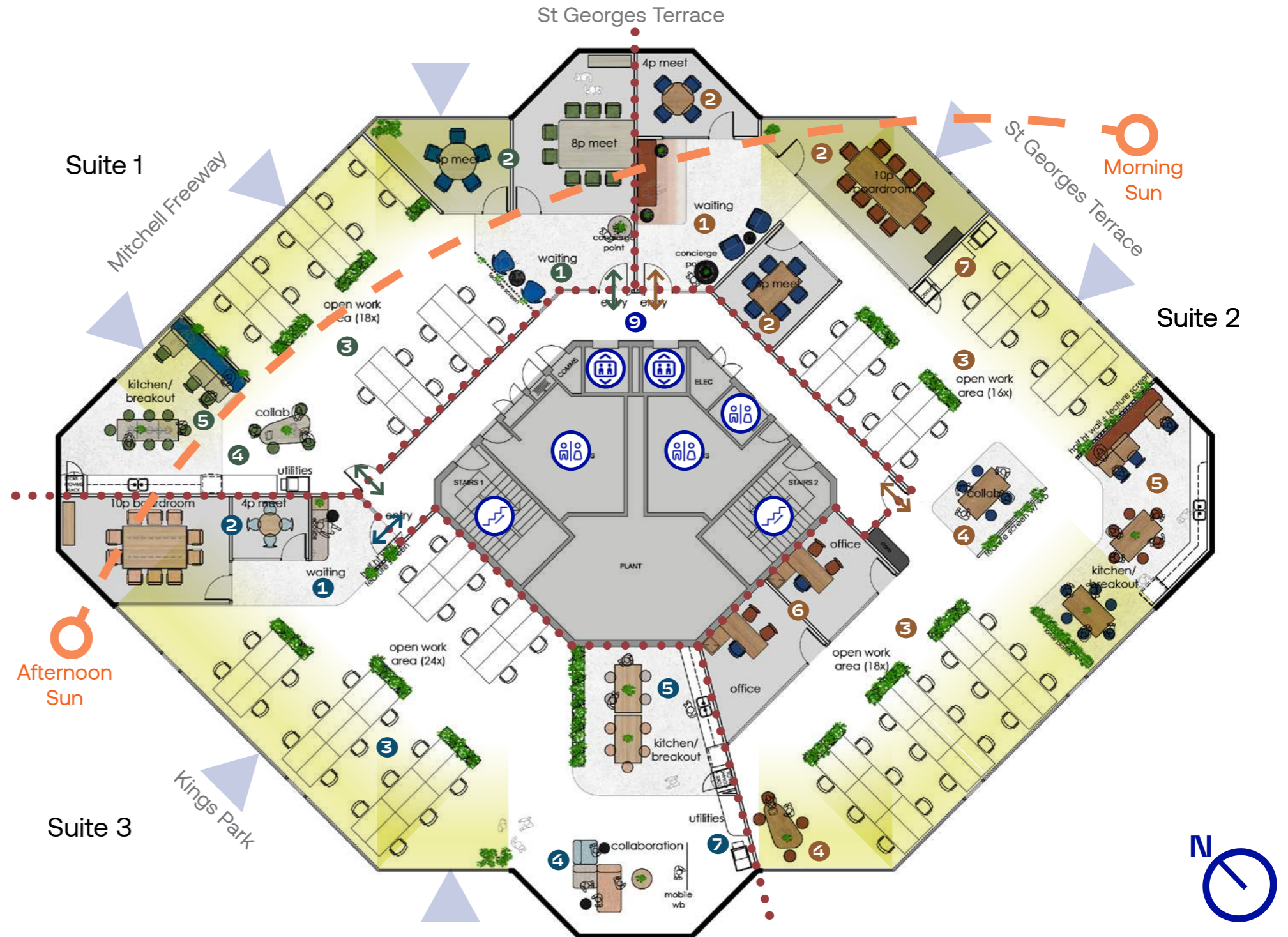

Design development Metrics & Zoning | Suite 1



| Accommodation Schedule | | |
|-------------------------------|-----------|------------|
| Space Type | Qty | Seat count |
| Individual workpoint | | |
| Workstations | 18 | 18 |
| Total | 18 | 18 |
| Informal collaboration | | |
| Collaboration area | 1 | 4 |
| Total | 4 | 4 |
| Formal collaboration | | |
| 8P Meeting Room | 1 | 8 |
| 5P Meeting Room | 1 | 5 |
| Total | 13 | 13 |
| Social | | |
| Kitchen/breakout | 1 | 14 |
| Waiting lounges | 1 | 2 |
| Total | 16 | 16 |
| Support | | |
| Utilities + Comms | 1 | - |
| Metrics | | |
| Area | 193 sqm | |
| Seat count | 18 | |
| Static Density | 10.7/sqm | |



Design development

Metrics & Zoning | Suite 2



| Accommodation Schedule | | |
|-------------------------------|-----------|------------|
| Space Type | Qty | Seat count |
| Individual workpoint | | |
| Workstations | 34 | 34 |
| Offices | 1 | 1 |
| Total | 36 | |
| Informal collaboration | | |
| Collaboration area | 2 | 8 |
| Total | 8 | |
| Formal collaboration | | |
| 10P Meeting Room | 1 | 10 |
| 6P Meeting Room | 1 | 6 |
| 4P Meeting Room | 1 | 4 |
| Total | 20 | |
| Social | | |
| Kitchen/breakout | 1 | 18 |
| Reception/waiting | 1 | 4 |
| Total | 22 | |
| Support | | |
| Utilities + Comms | 1 | - |
| Store | 1 | - |
| Metrics | | |
| Area | 362 sqm | |
| Seat count | 36 | |
| Static Density | 10.1/sqm | |

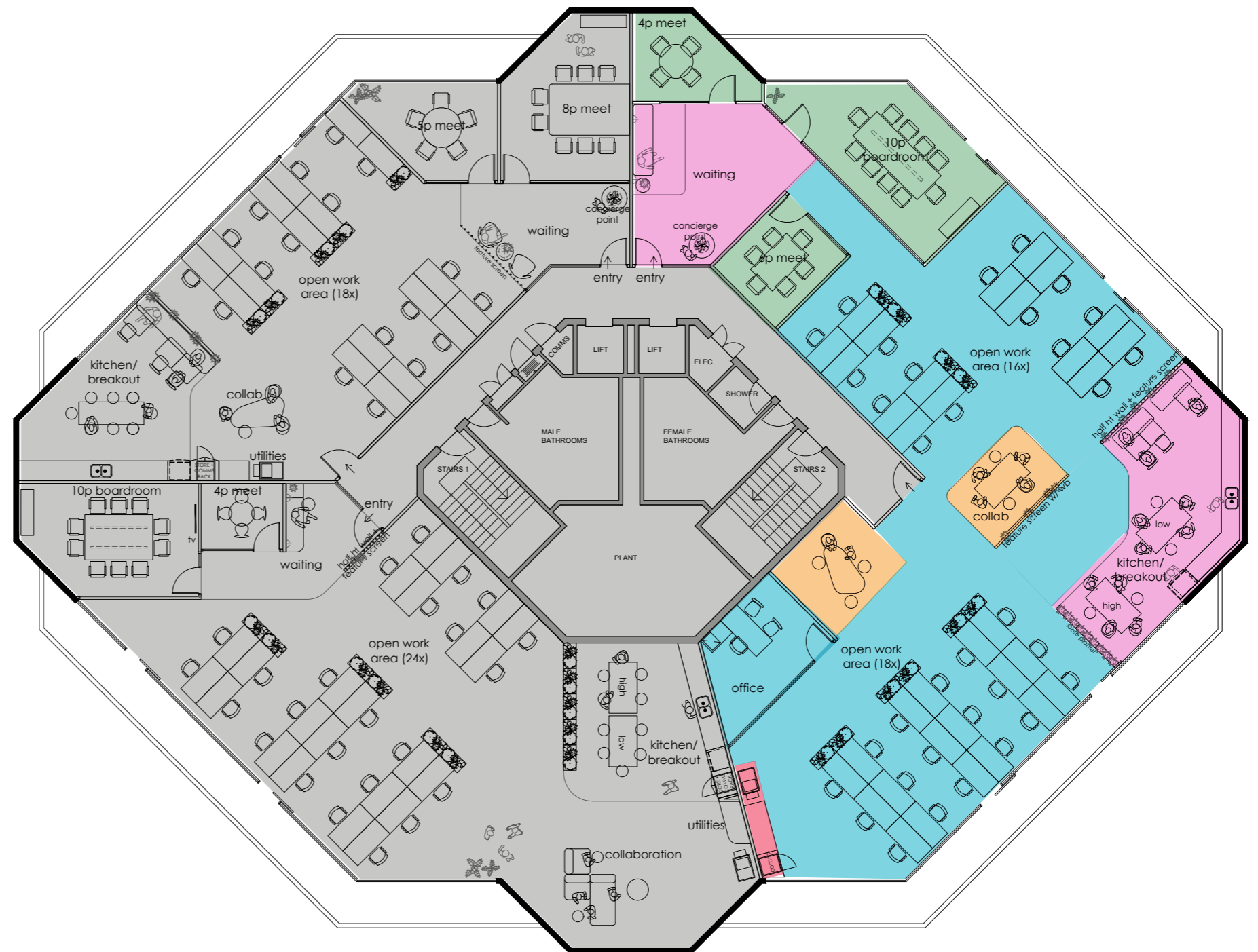

Design development

Metrics & Zoning | Suite 3



| Accommodation Schedule | | |
|-------------------------------|-----------|------------|
| Space Type | Qty | Seat count |
| Individual workpoint | | |
| Workstations | 24 | 24 |
| Total | 24 | 24 |
| Informal collaboration | | |
| Collaboration area | 1 | 4 |
| Total | 4 | 4 |
| Formal collaboration | | |
| 10P Meeting Room | 1 | 10 |
| 4P Meeting Room | 1 | 4 |
| Total | 24 | 24 |
| Social | | |
| Kitchen/breakout | 1 | 10 |
| Waiting | 1 | 2 |
| Total | 12 | 12 |
| Support | | |
| Utilities + Comms | 1 | - |
| Metrics | | |
| Area | 244 sqm | |
| Seat count | 24 | |
| Static Density | 10.1/sqm | |



Contact

Olive Miguel

Senior Interior Designer
omiguel@geyer.design

Patricia Espiritu

Interior Designer
pespiritu@geyer.design

Perth

Ground floor,
179 ST Georges Terrace,
Perth WA 6000

GEYER SERVICES PTY LTD

ABN: 43 632 093 120

ACN: 632 093 120

Copyright

© Geyer Services Pty Ltd 2023. All rights reserved. No part of the contents of this document may be reproduced or transmitted in any form, or by any means, by parties other than those employed or engaged by Centuria and only in connection with the purpose for which this document has been provided by Geyer Services without written permission of Geyer Services.

Confidential

This document contains confidential material solely for Centuria. All reasonable precautionary methods in handling the document and the information contained herein should be taken to prevent any third party for obtaining access. No responsibility is taken by Geyer Services for the use of this document by any third party.

| Revision | Date | Description | Distribution |
|----------|------------|--|--|
| [01] | 22.09.2023 | Design development | Centuria Matt Capone Centuria George Mair |
| [02] | 29.09.2023 | Updated elevations, and preferred finishes | Centuria Matt Capone Centuria George Mair |
| [03] | 09.11.2023 | Updated elevations and Suite 2 carpet finish | Centuria Matt Capone Centuria George Mair |

Olive Miguel

Senior Interior Designer
T: +61 8 9415 1015
E: omiguel@geyer.com.au

Patricia Espiritu

Interior Designer
T: +61 8 6381 4208
E: pespiritu@geyer.com.au

Sydney

Gadigal Land
Level 5,
23-33 Mary Street
Surry Hills NSW 2010
T: +61 2 8366 9300

Melbourne

Wurundjeri Woi Wurrumg Land
325 Flinders Lane,
Melbourne VIC 3000
T: +61 3 9491 8000

Brisbane

Meanjin Land
Level 4, Corbett Chambers
283 Elizabeth Street
Brisbane QLD 4000
T: +61 7 3739 3100

Perth

Whadjuk Land
Ground Floor
179 St Georges Terrace
Perth WA 6000
T: +61 8 9415 1015

Singapore

3 Pickering Street
#01-55 Nankin Row
Singapore 048660
T: +65 6594 9355

geyer.design