

This drawing and design is subject to copyright and may not be reproduced without prior written consent. Contractor to verify all dimensions on site before commencing work. Report all discrepancies to project manager prior to construction. Figured dimensions to be taken in preference to scaled drawings, all work is to conform to relevant Australian standards and other codes as applicable.

for BUILDING PERMIT

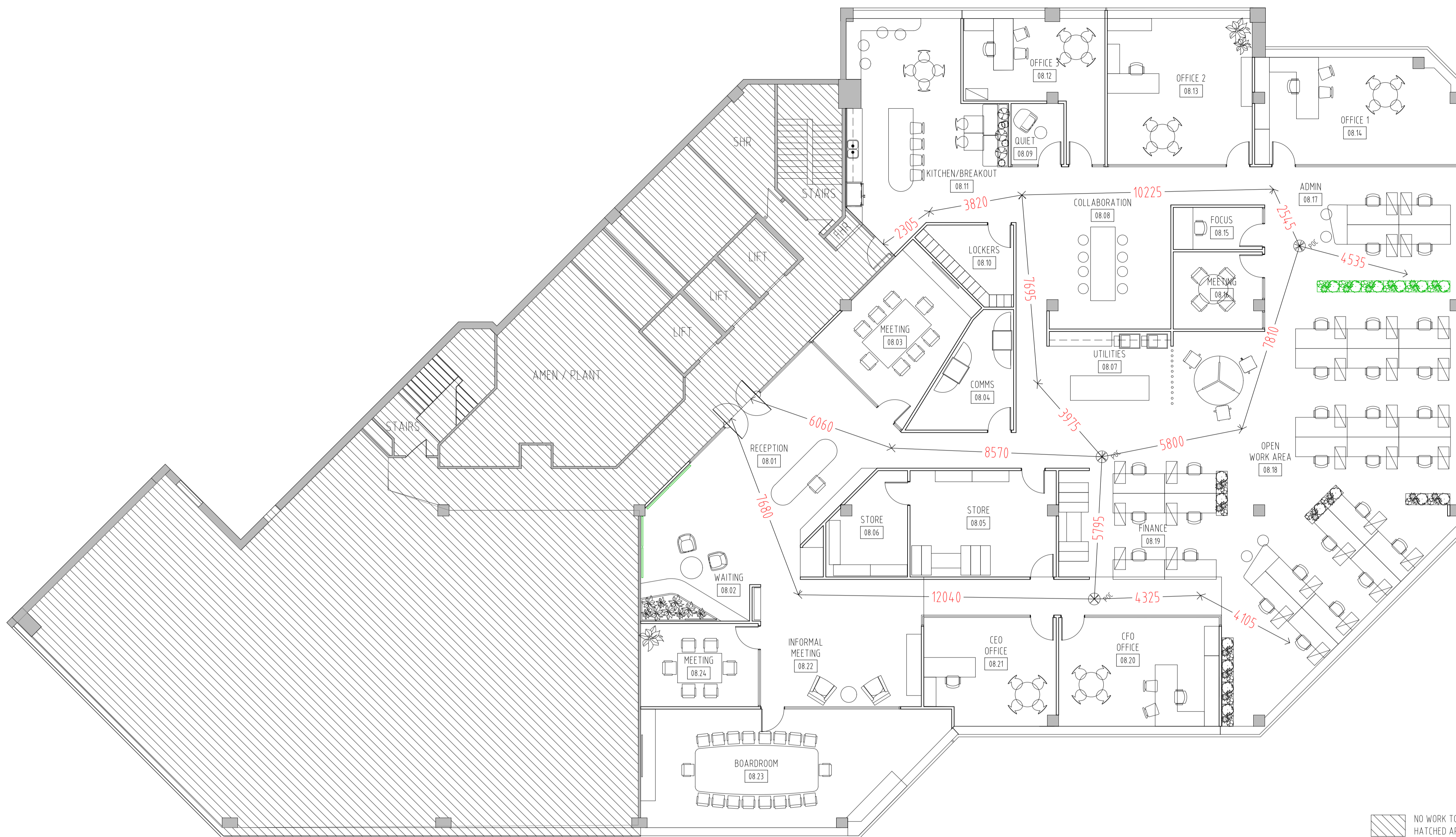

**CITY OF PERTH**  
**Building Permit**  
**BPC 2020/598**  
**Approved Plan 24/11/2020**

REVISION	DATE	DETAILS
E	18/11/20	ISSUE FOR BUILDING PERMIT
D	4/11/20	ISSUE FOR BUILDING PERMIT
C	2/11/20	ISSUE FOR BUILDING PERMIT
B	14/10/2020	ISSUE FOR TENDER
A	09/10/2020	ISSUE FOR APPROVAL

**valmont**  
 valmont - level 15, 111 st georges tce, perth 6000  
 p. 08 9415 1015 - w. www.valmont.com.au

client + address  
 SINOSTEEL  
 L8, 251 ST GEORGES TERRACE, PERTH WA 6000  
 drawing title  
 PATH OF TRAVEL PLAN

project no.	date	revision
20_W092	SEP 2020	<b>E</b>
drawn OM	designed KH	
scale 1:100	(A1 SHEET)	
drawing no. CD-008		

PRINT IN COLOUR

GENERAL PATH OF TRAVEL NOTES	PATH OF TRAVEL LEGEND
1. ALL PATHS OF TRAVEL FOR ACCESS AND EGRESS TO COMPLY WITH AS/ISO 21509 AND OTHER RELEVANT BUILDING CODES AND AUSTRALIAN STANDARDS.	← XXX → DISTANCES FOR PATH OF TRAVEL
2. PATHS OF TRAVEL ARE SHOWN INDICATIVELY. PLANS ARE SUBJECT TO APPROVAL BY ACCESS AND BCA CONSULTANTS	⊕ POC POINT OF CHOICE
3. ALL PATHS OF TRAVEL TO BE 900mm MINIMUM CLEAR UNOBSTRUCTED PATHS UNLESS INDICATED OTHERWISE.	